



# IMPROVED CERTIFICATIONS SEARCH TOOL. REGISTER NOW!

LEARN MORE

## Design No. U943 BXUV.U943 Fire-resistance Ratings - ANSI/UL 263

[Page Bottom](#)

### Design/System/Construction/Assembly Usage Disclaimer

- Authorities Having Jurisdiction should be consulted in all cases as to the particular requirements covering the installation and use of UL Certified products, equipment, system, devices, and materials.
- Authorities Having Jurisdiction should be consulted before construction.
- Fire resistance assemblies and products are developed by the design submitter and have been investigated by UL for compliance with applicable requirements. The published information cannot always address every construction nuance encountered in the field.
- When field issues arise, it is recommended the first contact for assistance be the technical service staff provided by the product manufacturer noted for the design. Users of fire resistance assemblies are advised to consult the general Guide Information for each product category and each group of assemblies. The Guide Information includes specifics concerning alternate materials and alternate methods of construction.
- Only products which bear UL's Mark are considered Certified.

### BXUV - Fire Resistance Ratings - ANSI/UL 263 Certified for United States

### BXUV7 - Fire Resistance Ratings - CAN/ULC-S101 Certified for Canada

[See General Information for Fire-resistance Ratings - ANSI/UL 263 Certified for United States Design Criteria and Allowable Variances](#)

[See General Information for Fire Resistance Ratings - CAN/ULC-S101 Certified for Canada Design Criteria and Allowable Variances](#)

## Design No. U943

October 09, 2018

**Bearing Wall Rating — 4 Hr (see Item 1)**

**Nonbearing Wall Rating — 4 Hr (see Item 1)**

**This design was evaluated using a load design method other than the Limit States Design Method (e.g., Working Stress Design Method). For jurisdictions employing the Limit States Design Method, such as Canada, a load restriction factor shall be used — See Guide BXUV or BXUV7**

**\* Indicates such products shall bear the UL or cUL Certification Mark for jurisdictions employing the UL or cUL Certification (such as Canada), respectively.**

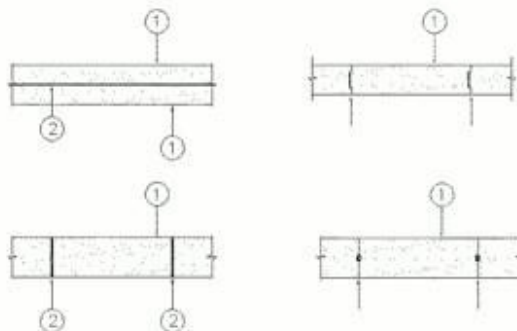

1. **Precast Autoclaved Aerated Concrete Wall Panels** — Min 4 in. thick by max 2 ft wide panels for 4 hr nonbearing wall rating. Min 6 in. thick by max 2 ft wide panels for 4 hr bearing wall rating. Panels installed either horizontally or vertically. Panels mechanically attached to the concrete floor and ceiling.

**AERCON FLORIDA L L C** — AC-3.3, AC-4, AC-4.4, AC-6, AC-6.6

2. **Thin Bed Mortar** — Horizontal and vertical panel joints coated with a ANSI A118.4 Latex/Portland cement thin bed mortar. Thin bed mortar is optional in 8 in. thick panels with tongue and groove joints for nonbearing walls.

3. **Caulking and Sealants** — (Optional) Applied to the horizontal and vertical joints. See Caulking and Sealants (BZYW) category for list of manufacturers.

4. **Steel Studs** — (Optional - Not shown - for use with items 5, 6 and 7) - Corrosion protected steel studs, min. 2-5/8 in wide, min. No. 20 MSG (0.0329 in. thick), cold formed, designed in accordance with the current edition of the Specification for the Design of Cold-Formed Steel Structural Members by the American Iron and Steel Institute. The max stud spacing of wall assemblies shall not exceed 24 in. O.C. Studs attached to floor and ceiling runners with 1/2 in. long Types S-12 pan head, self-drilling, self-tapping steel screws on both sides of the studs or by welded or bolted connections designed in accordance with AISI specifications.

4A. **Wood Studs** — (Optional - Not shown - for use with items 5, 6 and 7) - As an alternate to Item 4, nom. 2 in. by 4 in., spaced a max of 24 in. O.C. Stud to be effectively firestopped at the top and bottom of the wall with nom. 2 in. by 4 in. plates.

5. **Angles** — (Optional - Not shown - when used, items 4 or 4A, 6 and 7 must be used) - Angles 0.063 in. thick with one 2 in. leg and one 2-1/4 in. leg. Aluminum angles spaced a minimum of 32 in. vertically and 32 in. horizontally with Type W, min. 1-1/4 in. to max. 3 in. long screws secured through each angle leg at pre-drilled hole, studs (Item 4 or 4A) and precast autoclaved aerated concrete blocks (Item 1), 2-1/4 in. leg to be positioned on stud side and 2 in. leg to be positioned on AAC side.

6. **Gypsum Board\*** — (Optional - Not shown - for use with items 4 or 4A, 5, 6 and 7) - **Any 1/2 in. thick UL Classified Gypsum Board that is eligible for use in Design No. X515. Any 5/8 in. thick UL Classified Gypsum Board that is eligible for use in Design Nos. L501, G512 or U305.** One layer of nom. 1/2 in. or 5/8 in. thick by 48 in. wide boards installed vertically to wood studs or steel studs. Joints to occur at stud locations. Gypsum board attached to steel studs using 1 in. long Type S-12 steel screws spaced 8 in. O.C. along the edges and 12 in. O.C. in the field. Gypsum board attached to wood studs using 1-3/4 in. long galv. nails with 0.128 in. dia. shank and 7/16 in. dia. head, spaced 8 in. O.C. along the edges and in the field Screws and nails located a min. of 1/2 in. from side joints and 3 in. from end joints.

**ACADIA DRYWALL SUPPLIES LTD** ([View Classification](#)) — CKNX.R25370

**AMERICAN GYPSUM CO** ([View Classification](#)) — CKNX.R14196

**BEIJING NEW BUILDING MATERIALS PUBLIC LTD CO** ([View Classification](#)) — CKNX.R19374

**CERTAINTED GYPSUM INC** ([View Classification](#)) — CKNX.R3660

**CGC INC** ([View Classification](#)) — CKNX.R19751

**CONTINENTAL BUILDING PRODUCTS OPERATING CO, L L C** ([View Classification](#)) — CKNX.R18482

**GEORGIA-PACIFIC GYPSUM L L C** ([View Classification](#)) — CKNX.R2717

**LOADMASTER SYSTEMS INC** ([View Classification](#)) — CKNX.R11809

**NATIONAL GYPSUM CO** ([View Classification](#)) — CKNX.R3501

**PABCO BUILDING PRODUCTS L L C, DBA PABCO GYPSUM** ([View Classification](#)) — CKNX.R7094

**PANEL REY S A** ([View Classification](#)) — CKNX.R21796

**SIAM GYPSUM INDUSTRY (SARABURI) CO LTD** ([View Classification](#)) — CKNX.R19262

**THAI GYPSUM PRODUCTS PCL** ([View Classification](#)) — CKNX.R27517

**UNITED STATES GYPSUM CO** ([View Classification](#)) — CKNX.R1319

7. **Finishing System** — (Not Shown) - Vinyl, dry or premixed joint compound, applied in two coats to joints and screw-heads or nail heads, paper tape, 2 in. wide, embedded in first layer of compound over all joints. As an alternate, nom. 3/32 in. thick veneer plaster may be applied to the entire surface of the gypsum wallboard.

**\* Indicates such products shall bear the UL or cUL Certification Mark for jurisdictions employing the UL or cUL Certification (such as Canada), respectively.**

[Last Updated](#) on 2018-10-09

---

[Questions?](#)

[Print this page](#)

[Terms of Use](#)

[Page Top](#)

© 2018 UL LLC

The appearance of a company's name or product in this database does not in itself assure that products so identified have been manufactured under UL's Follow-Up Service. Only those products bearing the UL Mark should be considered to be Certified and covered under UL's Follow-Up Service. Always look for the Mark on the product.

UL permits the reproduction of the material contained in the Online Certification Directory subject to the following conditions: 1. The Guide Information, Assemblies, Constructions, Designs, Systems, and/or Certifications (files) must be presented in their entirety and in a non-misleading manner, without any manipulation of the data (or drawings). 2. The statement "Reprinted from the Online Certifications Directory with permission from UL" must appear adjacent to the extracted material. In addition, the reprinted material must include a copyright notice in the following format: "© 2018 UL LLC".